

MIDNIGHT MARQUEE

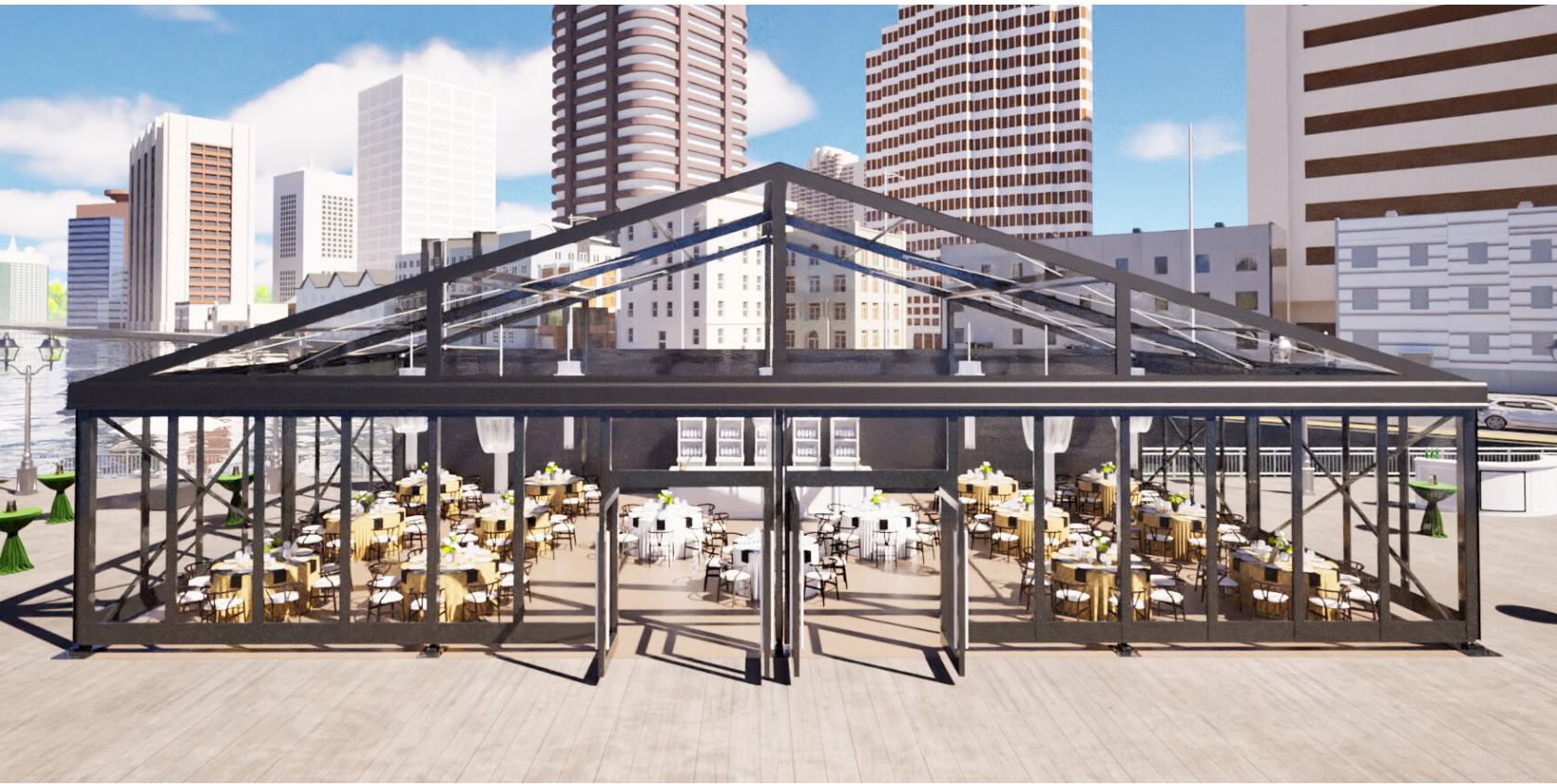

MIDNIGHT MARQUEE | CLEARSPAN

Engineered Elegance and Functionality. Experience the perfect blend of sophistication and practicality with the Midnight Marquee. Featuring a sleek black frame and a choice of clear or white ceilings, this marquee creates a stunning ambiance while offering ample space and versatility. Ideal for short-term events, semi-permanent installations, and long-term applications, the Midnight Marquee excels in efficient climate control and high rigging potential. Elevate your event to new heights with the unmatched benefits and special features that set the Midnight Marquee apart.

Profile: P3 **Width:** 10m (33'), 15m (50') and 20m (66') **Length:** Customizable by width
Perimeter Height: 4m (13') **Ridge Height:** 18' – 25'

HIGHLIGHTS

- **Engineered Midnight Frame:** Sleek black frame adds a modern touch.
- **Unobstructed Interiors:** No center poles, providing maximum space and clear views.
- **Long Term Installations:** Suitable for temporary, semi-permanent, and long-term setups.
- **Climate-Optimized:** Designed for temperature regulation in any season.
- **Heavy-Duty Rigging:** Easily supports AV equipment, lighting, and ceiling décor.
- **Flexible Modularity:** Customizable for intimate gatherings and large installations.
- **Wind Rated:** Site-specific engineering available for optimal wind resistance.
- **Snow Load Ratings:** Available in select styles and sizes.
- **Custom Branding Options:** Add logos, signage, or printed panels to showcase your brand.

MIDNIGHT MARQUEE



FEATURES

- **Ceiling / Top Panels:** White, black, clear with black trim or mixed panels
- **Sidewalls:** White, clear with black trim, glass, PVC hardwall, mesh and exit walls
- **Entrance Doors:** Single glass, double glass, double fabric, slider wall
- **Ceiling Liners:** White smooth
- **Leg Drapes:** White and custom
- **Perimeter Pole Covers:** Custom
- **Flooring:** Elevated, laydown heavy duty, and top floor covering
- **Bracket Options:** Hanging, mounting and rigging for décor, lighting and sound
- **External Protection:** Gutters and tent connectors
- **Anchor Options:** Stakes recommended or ballast weight
- **Ballast Weight Covers:** White, black, wood and custom

CONSIDERATIONS

Seasonal Use: Clear tops can create a greenhouse effect, requiring AC, side panels, and/or shade in the summer season and heating in cooler weather.

Cold Weather: Clear panels may crack below 36°F. Optional heating is available to reduce risk.

Weather Monitoring: Built to withstand tough conditions, proactive planning is essential for extreme weather events.

Surface Requirements:

- Flat, open space required for footprint, height clearance, install access, and ballasting.
- Uneven terrain? Elevated and laser-leveled floors are available.
- Anchoring options based on surface: stakes recommended; ballast weights optional.
- Obstacles such as trees, pools, planters, etc. can be assessed for custom installations.